

Step 1)  
If you have no existing  
batten, predrill keel on  
to subfloor.  
  
Screw down stainless  
fitting for keel.

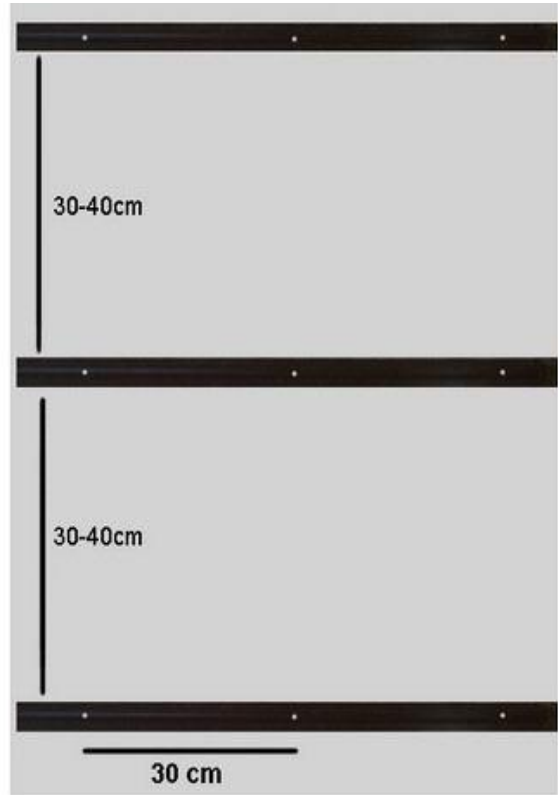

STEP 2)  
Keep keel approximately 30-40cm apart.  
  
Keep stainless fitting for keel approximately  
30cm apart

Step 3)  
Attach starter clip at the  
end of every keel with a screw

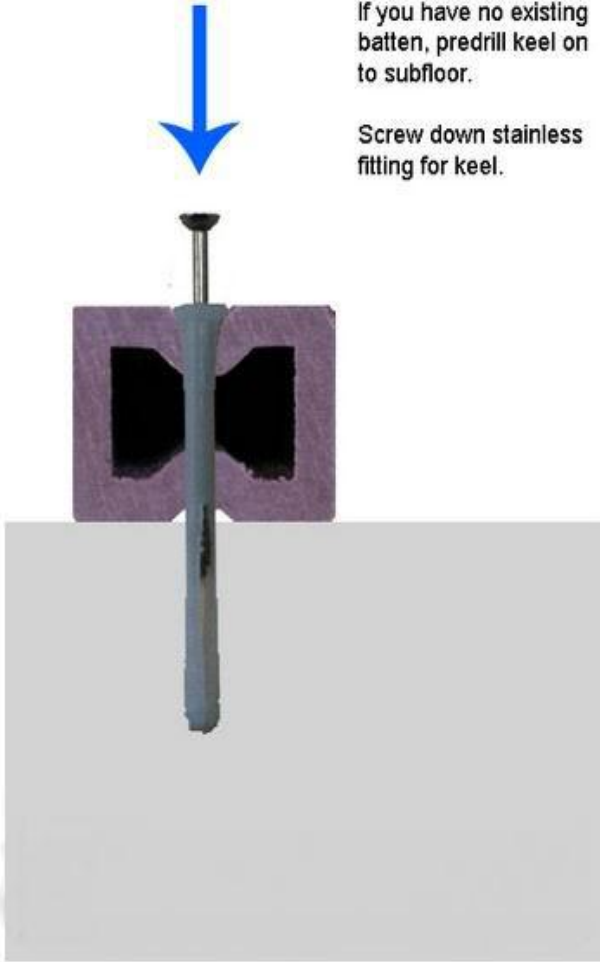

STEP 4) Slip the first WPC decking  
board firmly against the starter clip.

TOP VIEW

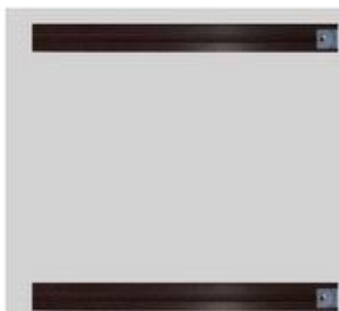

Step 5)  
Attach the spacer clip to the  
other side of the  
WPC decking board  
  
then fix the spacer clip  
with a screw down to the  
keel.

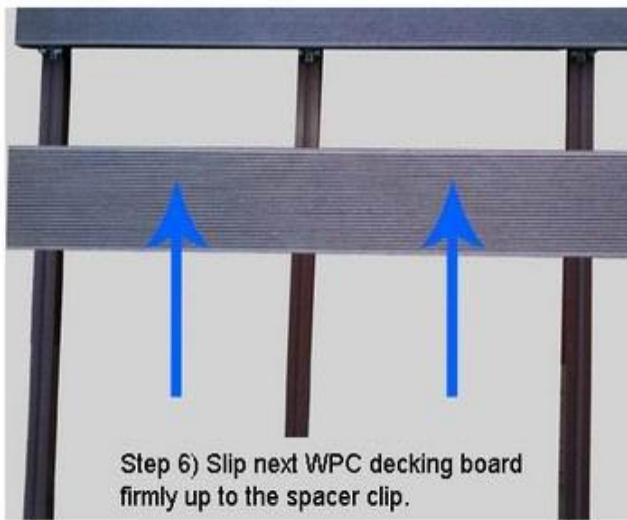

### More tips on installation:

1. Make sure the ground is flat or leveled before installation.
2. The composite wood planks can be easily cut/ screwed/ sawed.
3. If the deck planks are to be paved suspended, it's highly suggested to build the support frame with galvanized steel or other steel made materials.
4. If the decking are to be installed around the swimming pool, it's better to leave slope on the ground, to allow better water drainage
5. When it comes to the corner, it's suggested to leave some space (2-5cm) between decking and wall.

For more questions please contact us at [info@buildeck.com](mailto:info@buildeck.com).